

■ IMPACT ABSORBING STRUCTURE

1. General

The impact absorbing structure of the Land Cruiser/Land Cruiser Prado provides a body and frame construction that can effectively absorb the energy of impact in the event of a collision.

Also, an excellent occupant protection performance has been realized by adopting a frame construction that effectively absorbs and disperses the impact energy, and a strong body construction has been made possible through the use of the optimally allocated frame materials around the cabin.

2. Construction

Impact Absorbing Structure for Front Collision

Corner beads have been provided in the front area of the side rail, and the front of the side rail has plate material. Through these measures, the deformation of the frame can be controlled in accordance with the impact energy that is applied during a frontal collision, thus effectively absorbing the impact energy that is transmitted to the cabin and minimizing the deformation of the cabin.

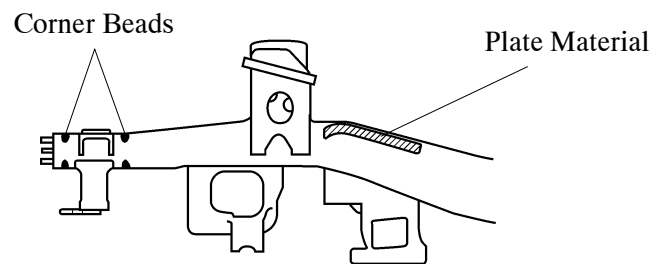

233BO06

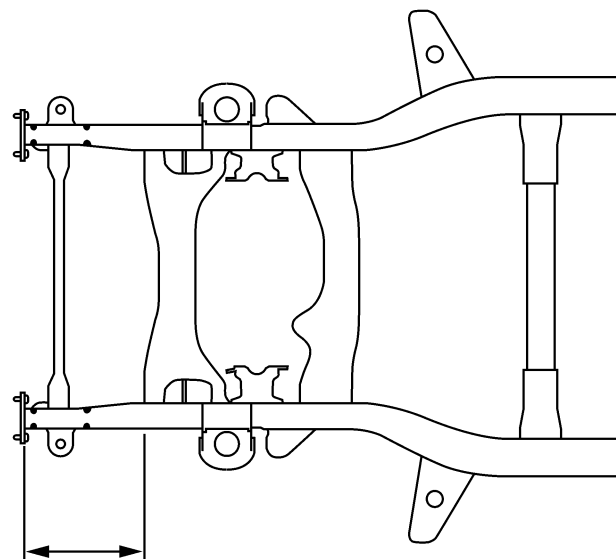

Energy Absorbing Area

233BO24

Impact Absorbing Structure for Side Collision

- Impact energy of a side collision directed to the cabin area is dispersed throughout the body via pillar reinforcements, side impact protection beams, floor cross members, etc. This dispersion of energy keeps the energy directed to the cabin to a minimum level. As a result, the deformation of the cabin is minimized.

► Impact Absorbing Structure for Side Collision ◀

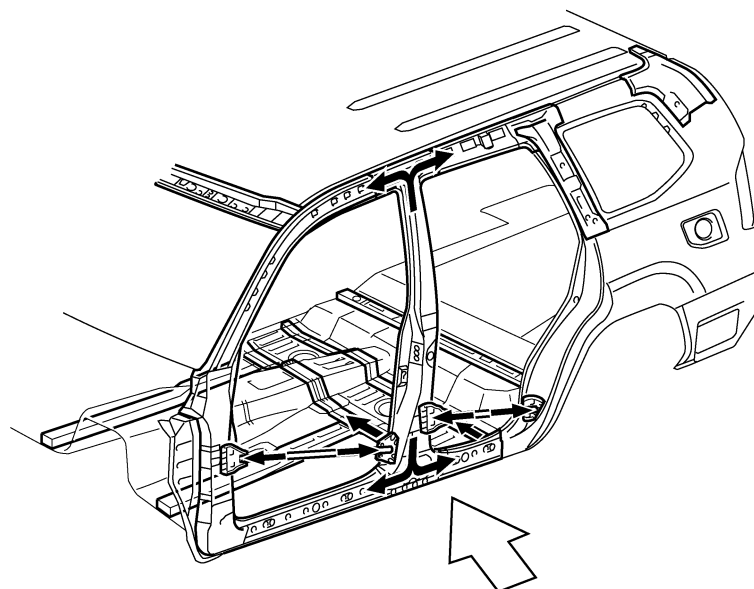

Side Impact Energy

233BO07

- A Head Impact Protection Structure has been adopted. With this type of construction, if the occupant's head hits against the roof side rail and pillar in reaction to a collision, the inner ribs of the roof side rail and pillars collapse to help reduce the impact.

► Head Impact Protection Structure ◀

 : Head Impact Protection Structure

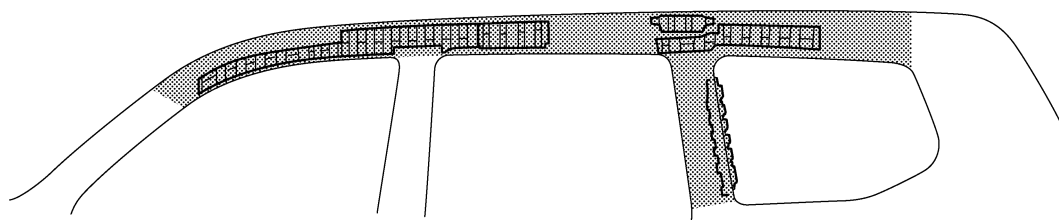

For model without Rear Air Conditioning, Curtain Shield Airbag, Moon Roof

233BO08